

Optical reference point: 2.2 mm from heatsink level. Choose PCB thickness to match LED focal point to the optical reference.

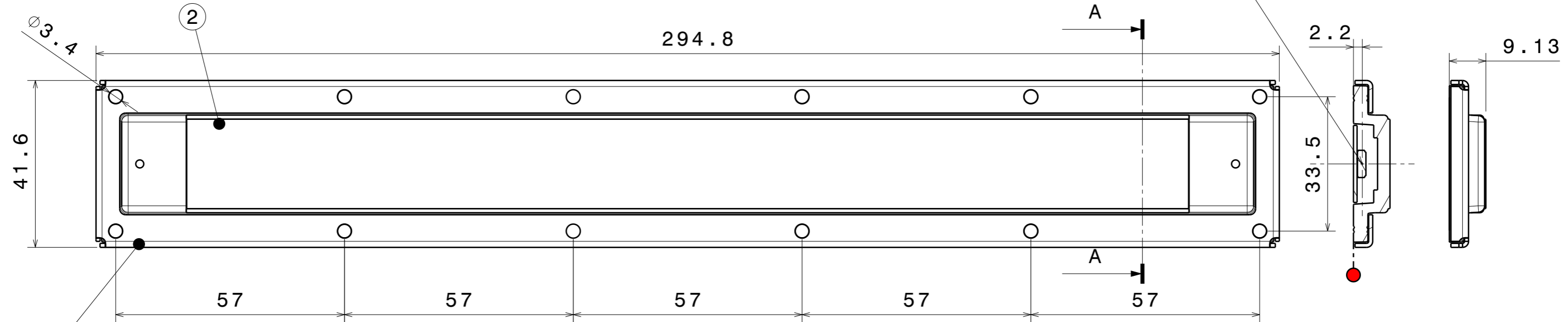

Section cut A-A
Scale: 1:1

FN18590_VIOLET-12X1-0

COMPONENTS

INDEX	PART	TYPE	MATERIAL	COLOR / COATING
1	F17192_VIOLET-12x1-FRAME	FRAME	STEEL	METAL
2	F18589_VIOLET-12x1-0	LENS	SILICONE	CLEAR

Oval beam pattern - light direction

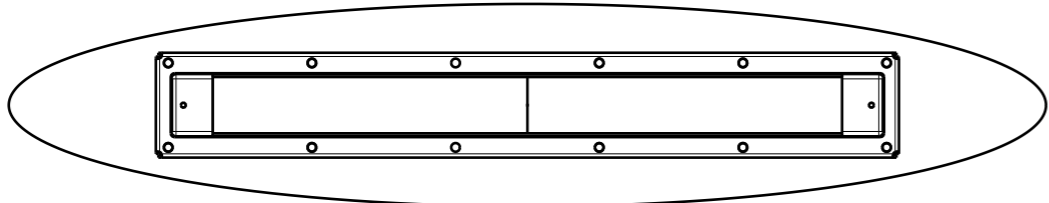

MECHANICAL DRAWING

PRODUCT
VIOLET 12X1



Plastic moulding general tolerances according to DIN 16901-130 and applies if not otherwise shown in the drawing. Silicone moulding general tolerances according to ISO 3302-1 Class M3 and applies if not otherwise shown in the drawing.

FIRST ANGLE PROJECTION:

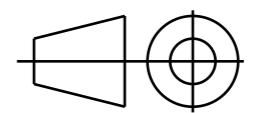

This drawing is the property of LEDiL Oy. It may not be copied or otherwise distributed without prior written permission from LEDiL Oy.

SCALE	1:1	WEIGHT	94,5g	A3	SHEET 1/1
-------	-----	--------	-------	----	-----------

Notes

●	Heatsink level.
●	LED location
	Ensure LED fitting from a product specific 3D model available from www.ledil.com
	For more details about installation please see LEDiL Installation Guide on www.ledil.com