

Cut out for
M3 x8

seal uncompressed
11

PCB max. dimension
147 x 46.2mm
Height: see section

Light
direction

Seal

installed
10.2

PART	TYPE	MATERIAL	COLOR / COATING
STRADA-IP-24-SEAL	Seal	Silicone	Translucent
SPORT-IP-24-FT6W-HT	Lens	Pmma	Clear
CS19001_SPORT-IP-24-FT6W-HT	Assembly		

MECHANICAL DRAWING

PRODUCT
Sport

LEDiL

Plastic moulding general tolerances according to DIN 16901-130 and applies if not otherwise shown in the drawing. Silicone moulding general tolerances according to ISO 3302-1 Class M3 and applies if not otherwise shown in the drawing.

FIRST ANGLE PROJECTION:

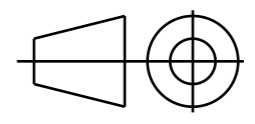

This drawing is the property of LEDiL Oy. It may not be copied or otherwise distributed without prior written permission from LEDiL Oy.

SCALE 1:1

WEIGHT 63g

A3 SHEET 1/2

- Notes**
- Heatsink level.
 - LED location
 - Circuit board layout drawing available
 - Ensure LED fitting from a product specific 3D model available from www.ledil.com
 - For more details about installation please see LEDiL Installation Guide on www.ledil.com

