

Wiring:  
PCB is fully sealed between the lens with silicone seal and the heatsink. Wiring needs to be done through the PCB and heatsink to maintain high IP rating.

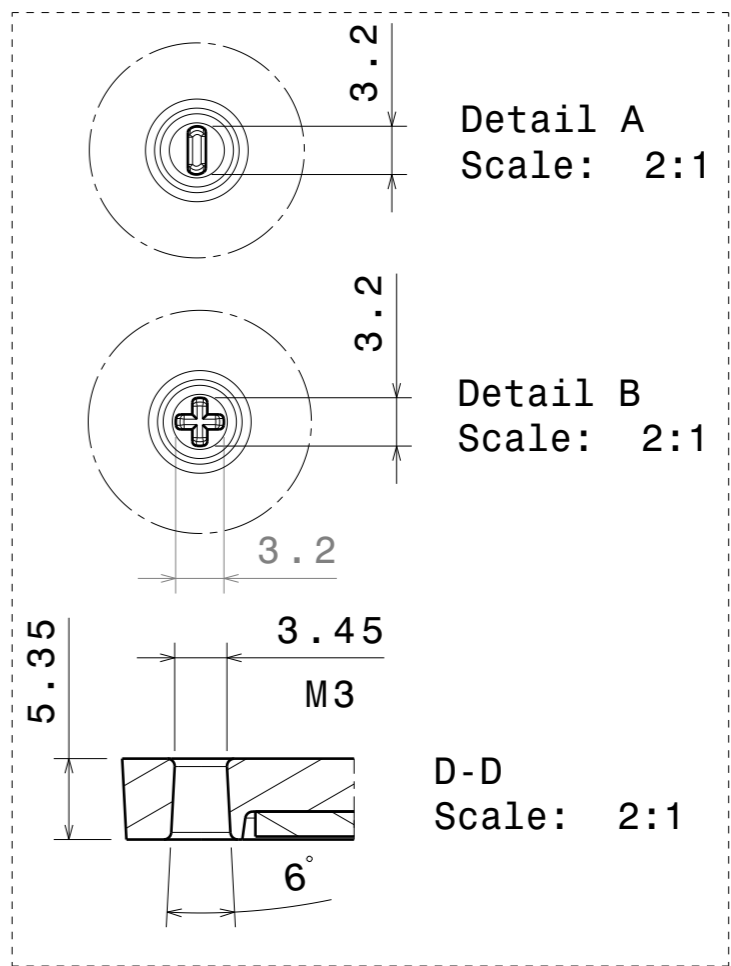

Detail A  
Scale: 2:1

Detail B  
Scale: 2:1

D-D  
Scale: 2:1

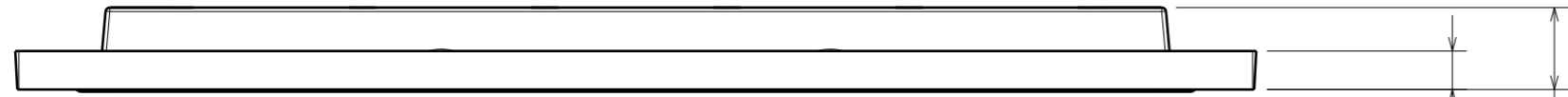

Fasten middle screws first. Recommended torque with pan head screw: 0.57Nm (for 1.6mm thick PCB, no thermal pad)

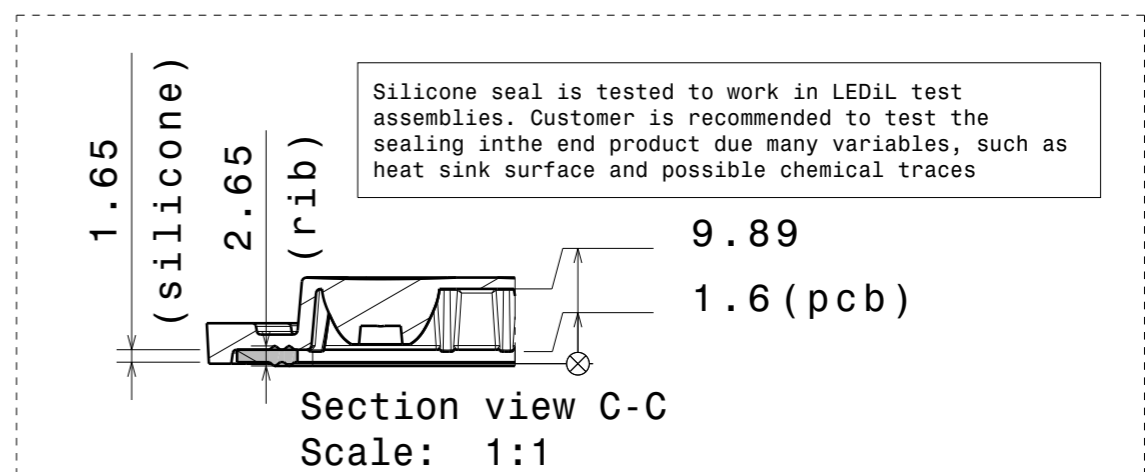

Section view C-C  
Scale: 1:1

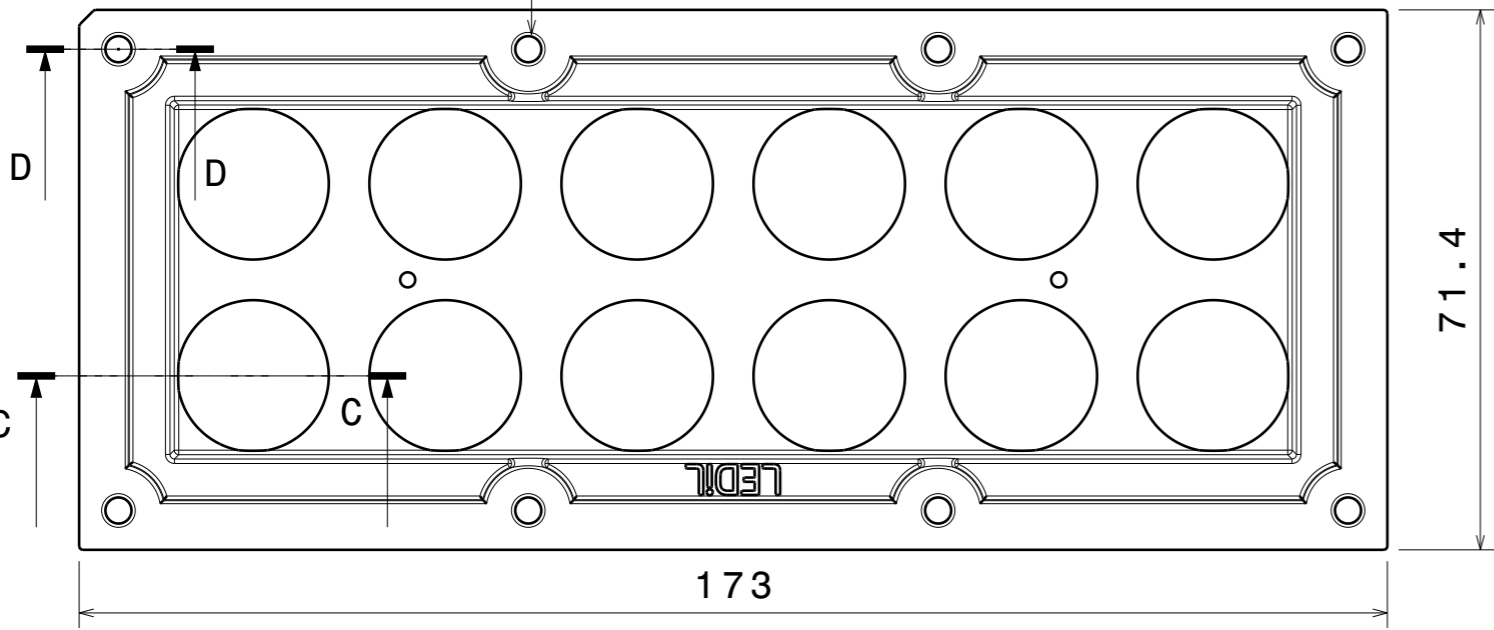

PART	TYPE	MATERIAL	COLOR / COATING
C17089_HB-IP-2X6-M-PC	Lens	PC	Clear
C14018_2X6-SEAL25	Lens	Silicone	White

**MECHANICAL DRAWING**  
PRODUCT  
**CS17090\_HB-IP-2X6-M-PC**



Plastic moulding general tolerances according to DIN 16901-130 and applies if not otherwise shown in the drawing. Silicone moulding general tolerances according to ISO 3302-1 Class M3 and applies if not otherwise shown in the drawing.

FIRST ANGLE PROJECTION:

This drawing is the property of LEDiL Oy. It may not be copied or otherwise distributed without prior written permission from LEDiL Oy.

SCALE	1:1	WEIGHT	-	A3	SHEET 1/1
-------	-----	--------	---	----	-----------

- Notes**
- PCB or heatsink level.
  - LED location
  - Ensure LED fitting from a product specific 3D model available from [www.ledil.com](http://www.ledil.com)
  - For more details about installation please see LEDiL Installation Guide on [www.ledil.com](http://www.ledil.com)