

CP19129_ AMY-50-0-C2
 CP19147_ AMY-50-0-C2-WHT
 CP18889_ AMY-50-0-C2-PC
 CP19382_ AMY-50-0-C2-WHT-PC

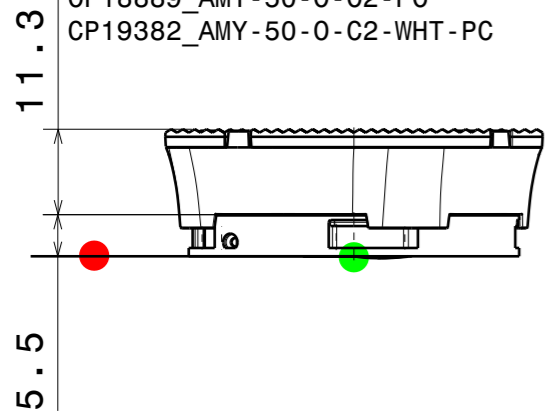

HEKLA
Connector

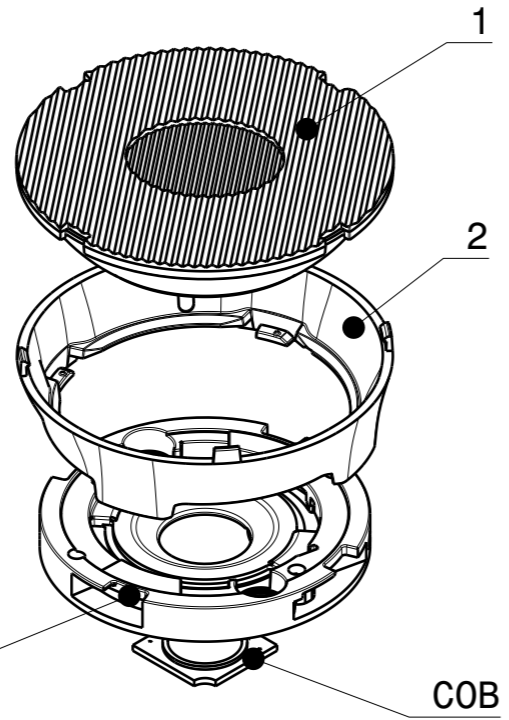

COB

CP19138_ AMY-50-0-B2
 CP19158_ AMY-50-0-B2-WHT
 CP18890_ AMY-50-0-B2-PC
 CP19390_ AMY-50-0-B2-WHT-PC

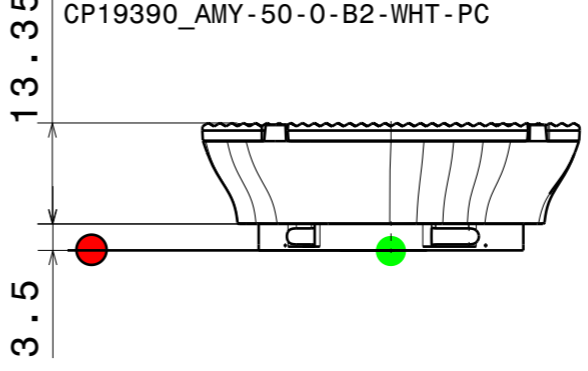

Connector
BJB / B+W 35mm-interface

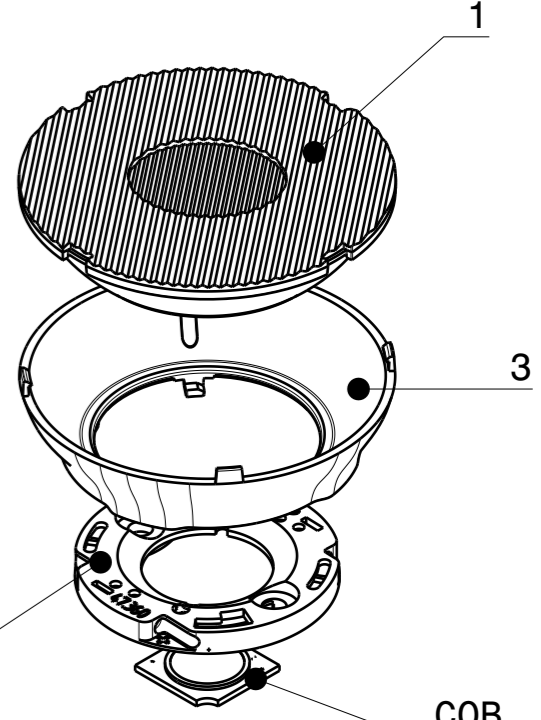

COB

Beam direction

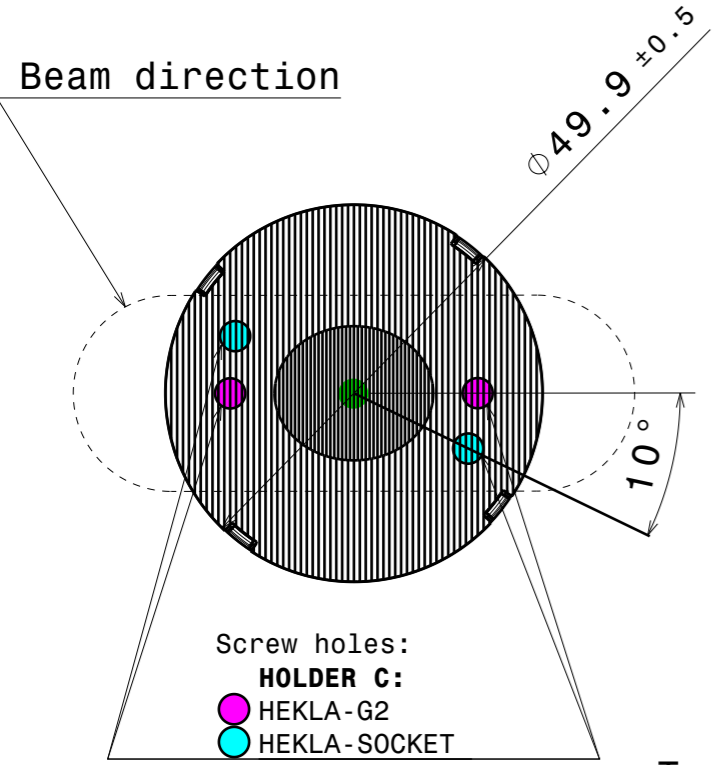

Screw holes:
HOLDER C:
 HEKLA-G2
 HEKLA-SOCKET

HOLDER B:
 Screw hole positions
 to be checked
 per socket/connector

Top view
 Scale: 1:1

INDEX	PART	TYPE	QTY	MATERIAL	COLOUR/COATING	ASSEMBLY CODES
1	AMY-50-0	LENS	1			
	C18490_ AMY-50-0			PMMA	CLEAR	
	C18888_ AMY-50-0-PC			PC	CLEAR	
2	HOLDER C	HOLDER 1				
	C19017_ AMY-50-HLD2-C			PC	BLACK	CP19129_ AMY-50-0-C2 CP18889_ AMY-50-0-C2-PC
	C19019_ AMY-50-HLD2-C-WHT			PC	WHITE	CP19147_ AMY-50-0-C2-WHT CP19382_ AMY-50-0-C2-WHT-PC
3	HOLDER B					
	C19018_ AMY-50-HLD2-B			PC	BLACK	CP19138_ AMY-50-0-B2 CP18890_ AMY-50-0-B2-PC
	C19020_ AMY-50-HLD2-B-WHT			PC	WHITE	CP19158_ AMY-50-0-B2-WHT CP19390_ AMY-50-0-B2-WHT-PC

MECHANICAL DRAWING

PRODUCT
AMY-50-0

Plastic moulding general tolerances according to DIN 16901-130 and applies if not otherwise shown in the drawing. Silicone moulding general tolerances according to ISO 3302-1 Class M3 and applies if not otherwise shown in the drawing.

FIRST ANGLE PROJECTION:

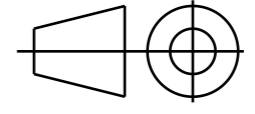

SCALE 1:1

WEIGHT -

LEDiL

This drawing is the property of LEDiL Oy. It may not be copied or otherwise distributed without prior written permission from LEDiL Oy.

A3 SHEET 1/1

Notes

	PCB or heatsink level.
	LED location
	Ensure LED fitting from a product specific 3D model available from www.ledil.com
	For more details about installation please see LEDiL Installation Guide on www.ledil.com

H G F E D C B A

4

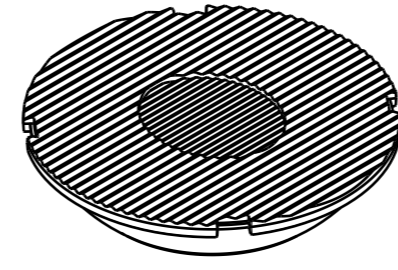
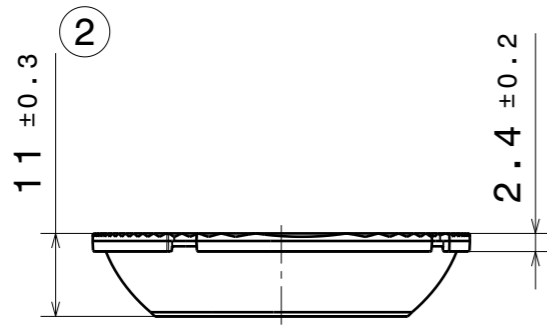

4

3

Beam direction

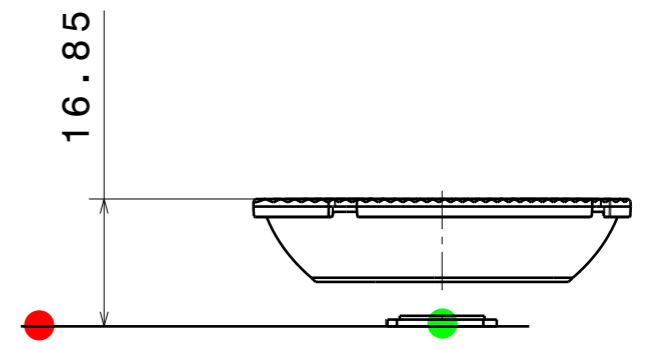
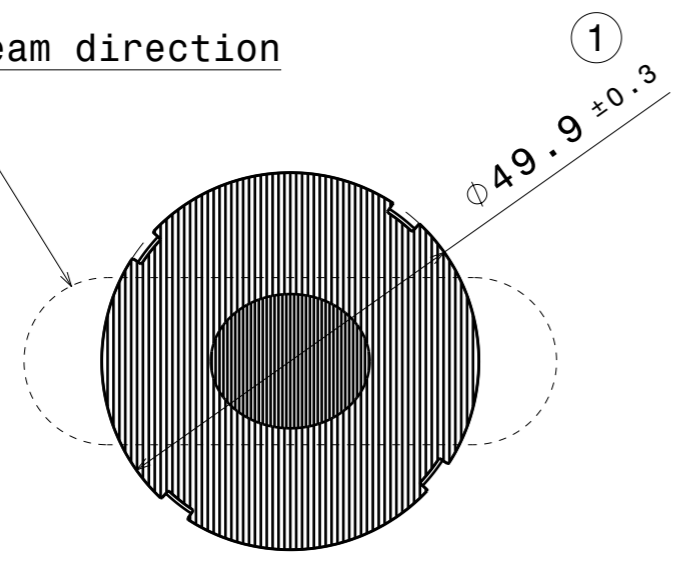

3

2

2

PART	TYPE	MATERIAL	COLOR / COATING
C18490_AMY-50-0	LENS	PMMA	CLEAR
C18888_AMY-50-0-PC	LENS	PC	CLEAR

MECHANICAL DRAWING		LEDiL
PRODUCT	AMY-50-0	
Plastic moulding general tolerances according to DIN 16901-130 and applies if not otherwise shown in the drawing. Silicone moulding general tolerances according to ISO 3302-1 Class M3 and applies if not otherwise shown in the drawing.	FIRST ANGLE PROJECTION: 	This drawing is the property of LEDiL Oy. It may not be copied or otherwise distributed without prior written permission from LEDiL Oy.
SCALE	1:1	WEIGHT -
		A3 SHEET 1/1

Notes

	PCB or heatsink level.
	LED location
	Ensure LED fitting from a product specific 3D model available from www.ledil.com
	For more details about installation please see LEDiL Installation Guide on www.ledil.com

H G F E D C B A

1

1